



Our Future Looks Cool: Indoor Housing for All Companion Animals

A GREAT PYRENEES NAMED ZEUS needed a cool place to get better. Zeus had an upper respiratory infection; he needed isolation from the rest of the pups on campus. Current isolation kennels on campus are small and without climate control, so Zeus spent a couple of weeks as an office foster sharing space with team member Jennifer Gross.

A gentle giant, Zeus was a pretty pitiful soul that first day. As we waited for the antibiotics to help, Zeus slept and sneezed, and slept and coughed, exhausted by his symptoms. But day two was a different story, Zeus was still sneezing and coughing a bit, but his spirit improved. Another week of antibiotics and Zeus was a fit, 115 pounds of big, furry, and sweet. He went up for adoption and had a brand-new home within a week.

Office fostering is popular with the staff. We love to support our mission and share our cooled space with pups in need of rest. Right now, it is a common practice on campus, as our dog kennels are half indoors and half outdoors, and there is no good way to keep them cool year-round. We're creative as we make the best of sheltering in an old facility; **our new shelter will give us control of the temperature and the air quality.**

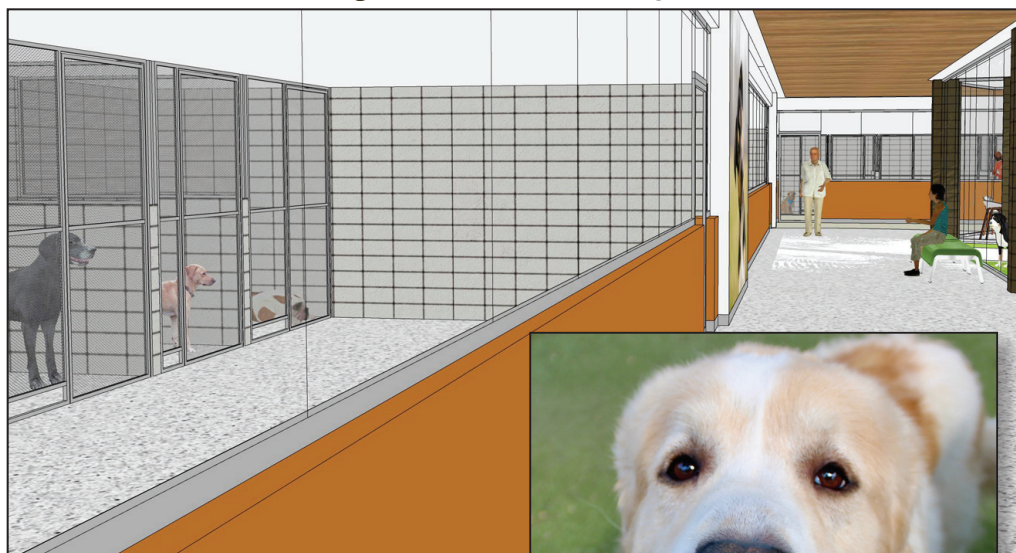

After 82 years of sheltering animals in the sunshine state, we recognize the health benefits to housing animals indoors with climate control and an air filtration system. Your new shelter will include Isolation kennels for ill animals, close to the medical suite and separate from those up for adoption. High-quality air purifiers will assist in containing all airborne illness and contribute to the respiratory health of our temporary residents. Your new SPCA Tampa Bay animal housing was designed by The Bacon Group, one of the few architects in the country who specialize in shelter design. Learn more about the benefits of the animal-centered design on page 2 of this issue.

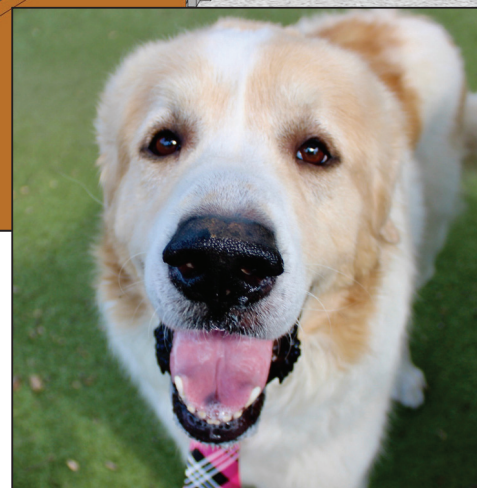

Andy Gaunce Leading the Board as we move toward A BETTER WAY HOME



AS PRESIDENT OF SPCA TAMPA BAY'S BOARD OF DIRECTORS, attorney Andy Gaunce is committed to helping the organization achieve its vision for the future. Andy and his wife Meredith, also an attorney, are the two halves that make St. Petersburg's Gaunce Law whole. Together, they provide legal counsel to business owners and entrepreneurs in the community.

Not only are Andy and Meredith partners in business, they're also parents to young son Noah, and they share a passion for senior rescue pups. With an eye to the future, Andy and Meredith have made a multi-year financial commitment to help SPCA Tampa Bay build A BETTER WAY HOME for the animals in its care and the people who love them.

Join Andy and Meredith in supporting SPCA Tampa Bay's effort to build A BETTER WAY HOME by making a multi-year pledge or a one-time gift to the campaign. For more information, please contact Laura LeBlanc Corry, Sr. Director of Campaigns, at (727) 586-3591 ext. 130.

CAPITAL CAMPAIGN CABINET**Betsie Scott**

Capital Campaign Cabinet Co-Chair

Carrie O'BrienCapital Campaign Cabinet Co-Chair
USF St. Petersburg**Jonathan Browy**

First Citizens Bank

CAPITAL CAMPAIGN ADVISOR**Council Member Ed Montanari**

City of St. Petersburg

CAPITAL CAMPAIGN LEADERSHIP**Martha Boden**

CEO

Carolyn Wisniewski

Chief Philanthropy Officer

FOR MORE INFORMATION**Laura LeBlanc Corry**

Sr. Director of Campaigns

LLeblancorry@spcatampabay.org

Jennifer Gross

Director of Philanthropy

JGross@spcatampabay.org

Kristi Koehler

Donor Relations Manager

KKoehler@spcatampabay.org

Laura Stricklin

Administrative Coordinator

LStricklin@spcatampabay.org

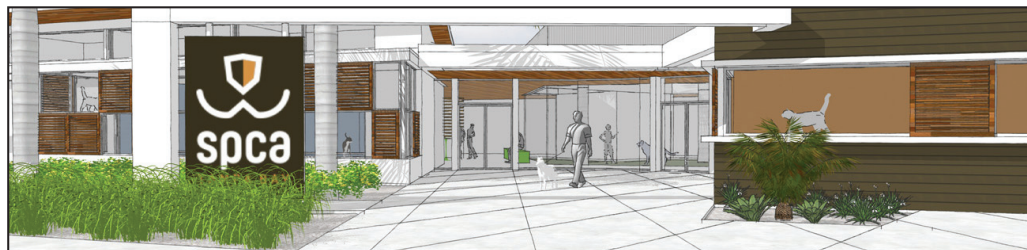
SPCATampaBay.org/betterwayhome**SPCA Tampa Bay Largo Shelter**
9099 130th Ave. N, Largo, FL 33773**SPCA Tampa Bay Veterinary Center**
3250 5th Ave. N, St. Petersburg, FL 33713
SPCATampaBay.org**Bacon Group, Inc. pairs vision with education to modernize our animal housing**

"WE WANT TO GIVE OUR COMMUNITY a for-all shelter that reflects the deep love and compassion it has for animals," CEO Martha Boden explains. "Many shelters across the country have become destinations with beautiful, welcoming spaces that encourage adopters to take their time and enjoy the wonderful variety of companion animals we have up for adoption."

Within six months of opening their new adoption center, designed by Bacon Group, Inc., Atlanta Humane nearly doubled their number of adoptions, which means they were quickly able to help twice the number of homeless pets! By creating a beautiful environment, designed to highlight adoptable pets and help them put their best paw forward, the new SPCA Tampa Bay Adoption Center will greet visitors with our mission immediately. As you walk in, the entrance will be flanked by screened enclosures where adoptable cats can watch the action and lay in the sun.

"Rick's idea for the 'catios' was a huge hit with our whole team," Martha says. "They include

these great louvers the cats can stay behind if they want to watch without being seen." It's that kind of informed attention to detail that Bacon Group, Inc. brings to every project.

Our new Adoption Center design will provide more natural light and incorporate better acoustic design to help control noise, which reduces stress for both animals and people. An atrium in the center of the space will allow families to "meet and greet" dogs up for adoption in a natural setting. Our feline housing will allow for social cats to share space with other social kitties, and modular design will allow for dividers to give solitary cats the space they desire. All these animal-centric details will be complemented by a layout that increases efficiency and better prevents the spread of illness.

Your new SPCA Tampa Bay shelter will compassionately support people and animals to further our vision of a community where every animal matters.

Meet Laura! Bringing new animal lovers into the fold to build A BETTER WAY HOME

LAURA LEBLANC CORRY, also known around the office as LLC, comes to SPCA Tampa Bay with a decade of experience in development in the nonprofit sector. Laura brings her professional experience and love of meeting new people to the role of Senior Director of Campaigns. She'll oversee strategy for the BETTER WAY HOME capital campaign, with a special focus on introducing new supporters to the mission and vision of our organization. Laura feels the humanness every day when she snuggles up to her beloved rescue, Winston, and she just loves to connect with fellow animal lovers about the special bond between humans and their pets.

Before joining SPCA Tampa Bay, Laura spent nearly six years at Ruth Eckerd Hall as Membership and Major Gift director. Prior to that, she worked in donor relations for the House of Blues Music Forward Foundation in Los Angeles.

Laura is a lifelong performer and received her BMUS in Professional Music from Berklee College of Music. She lives in St. Pete with her husband Ian and their dog Winston. When not out and about advocating for the mission of SPCA Tampa Bay, Laura can be found sampling a sour beer varietal at one of our area's many craft breweries, tackling an ambitious new recipe in the kitchen, or singing along to her favorite original Broadway cast recordings.

SPCA TAMPA BAY IS A REGISTERED 501(c)(3) NONPROFIT. A COPY OF THE OFFICIAL REGISTRATION (CH1173) AND FINANCIAL INFORMATION MAY BE OBTAINED FROM THE DIVISION OF CONSUMER SERVICES BY CALLING TOLL FREE 1-800-435-7352 WITHIN THE STATE. REGISTRATION DOES NOT IMPLY ENDORSEMENT, APPROVAL, OR RECOMMENDATION BY THE STATE. THIS ORGANIZATION RETAINS 100% OF ALL CONTRIBUTIONS RECEIVED.